

Michael F. Hoops, Mayor
Emily C. Davis, Councilmember
David H. Fox, Councilmember
Joe R. Beasley, Councilmember
Jonathan E. Hankins, Councilmember
Zachary T. Cline, Councilmember
Danny C. Willis, Councilmember

AGENDA
TOWN OF TAZEWELL, VIRGINIA
Special Called Town Council Meeting
Tuesday, January 7, 2025
6:00 p.m.
Town of Tazewell Council Chambers

❖ **SPECIAL CALLED MEETING – WORK SESSION (6:00 p.m.)**

1. Call to Order (Mayor)
2. Lincolnshire Aqua Park *
(Manager Regon)
3. 2025 Objectives and Goals – Roundtable Discussion
4. Miscellaneous Public Comment
5. Adjournment

2

LINCOLNSHIRE AQUA PARK



www.baselineLLC.com

3600 Henson Road, Knoxville, TN 37921

tel: (865) 588-4320 • fax: (865) 588-4111

e-mail: info@baselineLLC.com

www.baselinellc.com

PROPOSAL

TO: Donny Pruitt, Town of Tazewell, 211 Center Avenue, Tazewell, VA 24651. JOB: Lincolnshire Park fields. LOCATION: Tazewell. PHONE: 276 385-0692. DATE: July 25, 2024. Email: tazpw@taztown.org

We hereby submit specifications and estimates for:

Renovation of baseball infield - 2 Fields Approximately 39,000 sq ft - \$66,300.00
Scope of work to include the following:

- Demo - Excavate and remove contaminated infield material, scraping grass and roots from the area adjacent to the dugouts and backstop. Also reset infield/outfield intersection by scribing a new arc.
Grading - Cut the perimeter of the infield to establish a consistent edge between infield and outfield. The infield will be regraded to a more consistent slope adding clay as necessary to raise low areas; paying close attention to the halo at and behind home plate and the pitcher's mound. Add sod as necessary back to infield/outfield edge.
Drainage - Install French drain system - 3 runs across each infield and provide outlet to connect to existing drainage or for connection by others. French drain shall be 2' x 2' with 4" perforated pipe and geotextile liner.
Infield Clay - add up to two inches of infield mix clay to provide new compacted surface. Provide new home plate and pitching rubber as necessary.
Field Conditioner - apply a layer of field conditioner to the graded infield to provide playing surface.

Work not included: any work associated with storm drainage away from the field or the outfield grass.

WE PROPOSE TO PERFORM THE ABOVE NAMED WORK FOR THE SUM OF: see above

All material and workmanship are guaranteed for one (1) year after completion unless otherwise specified. Payment in full to be made upon completion of the described work. 1 1/2% interest per month will be applicable to any unpaid balance ten days after the invoice date.

Valid Through: 30 days

Submitted: [Signature] Will Ferguson

Acceptance of Proposal: The above prices, specifications, and conditions are satisfactory and are hereby accepted. Baseline Sports Construction, LLC is authorized to do the work as specified. Payment will be made as outlined above.

DATE OF ACCEPTANCE: SIGNATURE:





www.baselineLLC.com

3600 Henson Road, Knoxville, TN 37921

tel: (865) 588-4320 • fax: (865) 588-4111

e-mail: info@baselineLLC.com

www.baselinellc.com

PROPOSAL

| | |
|---|--|
| TO: Donny Pruitt Town of Tazewell 211 Center Avenue Tazewell, VA 24651 Email: tazpw@taztown.org | JOB: Lincolnshire Park fields LOCATION: Tazewell PHONE: 276 385-0692 DATE: September 17, 2024 |
|---|--|

We hereby submit specifications and estimates for:

Renovation of baseball outfields - 2 Fields Approximately 127,000 sq ft total

Scope of work to include the following:

- Demo - Excavate and remove existing turf, scraping grass and roots from the area beyond the infield to the extent of the outfield using 100 hp tractor and Combinator attachment we will remove approximately 2" of existing turf and root mass to approximately 305' from home plate.
- Irrigation – utilize existing water source and provide irrigation throughout the outfield. We will install a new irrigation system in the outfield. We will also install a quick coupler in the infield near pitching mound for use to keep clay moist. Outfield will have 7 to 8 zones to cover the new turf. Water and 120 v.a.c power supply is provided by others and assumed to be within 30' of the field.
- Laser Grading – The outfield will be regraded to a more consistent slope to improve drainage. We propose to disc the fields after removing the 2" of existing material. Once a disc has been used on the field then we can grade the subgrade to slope. After subgrade has been laser graded, we recommend installing 2" of concrete sand or river sand. This will be applied with the laser. We will then disc the field 4" deep to blend the 2" of course sand with existing soil. This will then be laser graded again to provide a sandy root zone.
- Sod – Provide and install Bermuda or Bluegrass sod. 63,540 sf of Bermuda sod installed per field, rolled and fertilized.
- Top Dressing - Using a tow behind top dresser pulled by a tractor with high flotation turf tires we will apply 2 loads of sand to the field approximately 2 weeks after installation. Using a metal mat drag and 4-wheeler, we will drag the sand into any gaps or low spots of the sod. After dragging sand, we will fertilize fields and water in.

WE PROPOSE TO PERFORM THE ABOVE-NAMED WORK FOR THE SUM OF: \$390,110.00

All material and workmanship are guaranteed for one (1) year after completion unless otherwise specified. Payment in full to be made upon completion of the described work; 1 1/2% interest per month will be applicable to any unpaid balance ten days after the invoice date.

Valid Through: 30 days

Submitted

Will Ferguson

Will Ferguson

Acceptance of Proposal- The above prices, specifications, and conditions are satisfactory and are hereby accepted. Baseline Sports Construction, LLC is authorized to do the work as specified. Payment will be made as outlined above.

DATE OF ACCEPTANCE: _____ SIGNATURE: _____



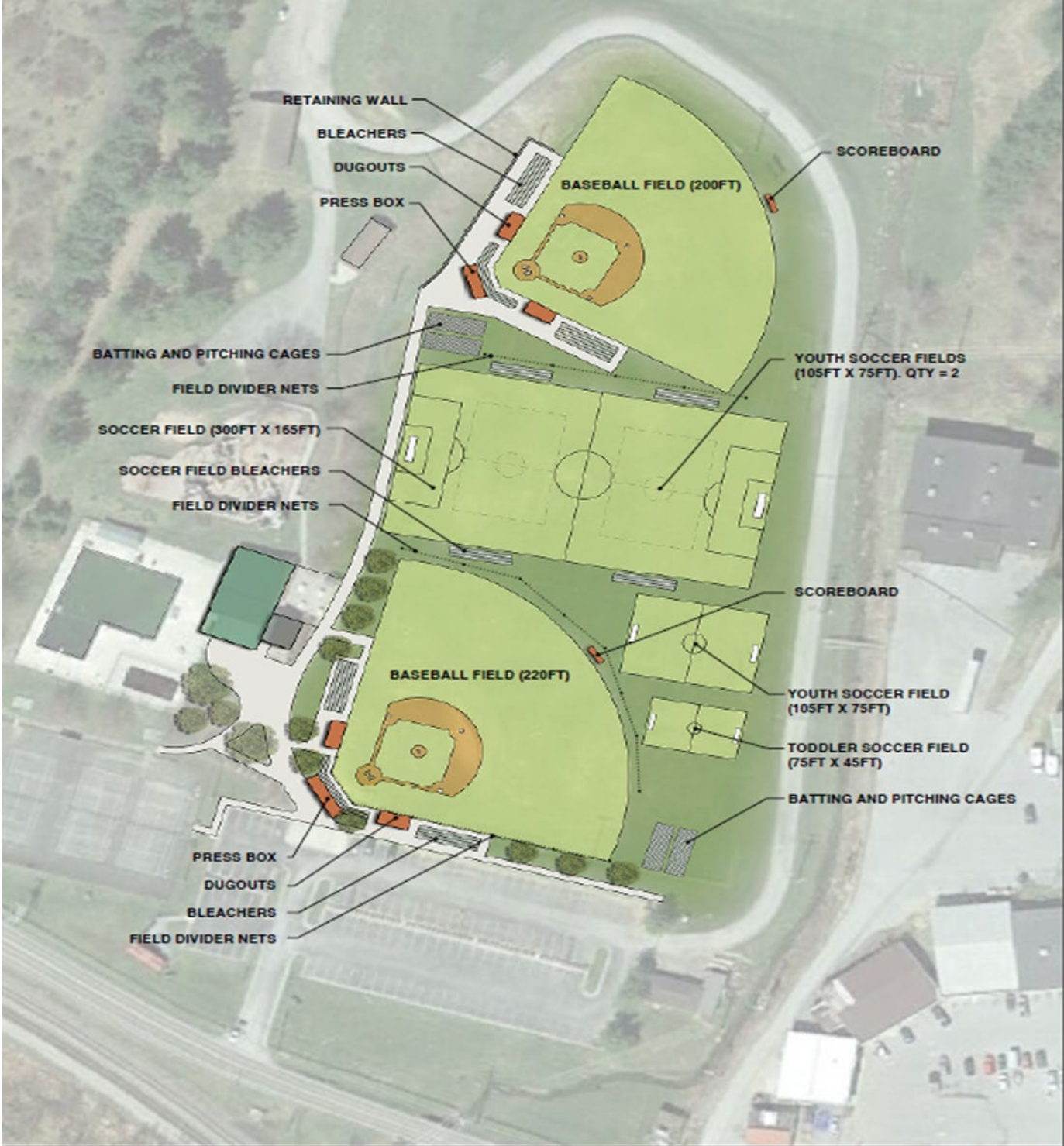

TAZEWELL SPORTS FIELDS
SCHEMATIC MASTER PLAN

sitework
STUDIOS









I have the prices together for aqua park replacement inflatables. If you need written estimates from the companies I got the prices from just let me know and I can get that done – I pulled these prices off online stores.

Aquaglide.com

Freefall Supreme TR (big slide) – 14,699.99

Jungle Joe TR (the one we had to pull off the water this year) – 9,999.99

Catapult (Swing) – 3,899.99

Kaos – 5,799.99

Speedway 20 (walkways) – 1,999.99 x 3 – 5,999.97

Wibit

Recreonics.com

Hurdle (walkway connector) – 2,390.00

Total would be 42,789.93 plus shipping.

As far as the other inflatables that are up there I do not have any information on how old they are so I don't really have a guess on how much longer they will hold up. The information I have above, are the inflatables that are currently losing air and have to be filled at least twice a day with moderate to heavy use.

Let me know if you need more information. I tried to include all the details for everything.

Greg Quesenberry

Recreation Director

Town of Tazewell, VA

276 979 5909

townoftazewell.org

Initial Investment for the Aqua Park

| Account Detail | | | | | |
|-----------------------|-----------------------------|---|---------------|--|--|
| Account | Account Description | Description | Debit | | |
| 001-027-8900 | Recreation Parks & Programs | CECIL ENGINEERING, CO. PC Preliminary-Sports Complex/Adventure Park 12/17-1/18 | \$ 13,390.00 | | |
| 001-027-8900 | Recreation Parks & Programs | IDEXX E-COLI TEST-LINCOLN PARK (AQUA PARK) | \$ 1,778.35 | | |
| 001-027-8900 | Recreation Parks & Programs | IDEXX E-COLI TEST-LINCOLN PARK (AQUA PARK) | \$ 1.81 | | |
| 001-027-8900 | Recreation Parks & Programs | VIBE KAYAKS LLC KAYAKS & PADDLE BOARDS FOR THE AQUA PARK | \$ 9,303.00 | | |
| | | | | | |
| | | SOUTHERN STATES 2X4'S | \$ 34.32 | | |
| | | LOWES -TRUSSES FOR BUILDING | \$ 1,080.00 | | |
| | | DILLON & COMP-BLOCK | \$ 705.00 | | |
| | | CENTRAL SUPPLY -CONCRETE | \$ 812.00 | | |
| | | LOWES -DECKING BOARDS 2X6 | \$ 2,291.41 | | |
| | | COMMERCIAL RECREATION SPECIALIST - | \$ 46,751.35 | | |
| | | TAZ FARM BUREAU-SILK FENCE | \$ 59.40 | | |
| | | K O TRUCK PARTS -SAND | \$ 49.95 | | |
| | | METALLIC LADDER-DOCK | \$ 2,489.50 | | |
| | | QUIKRETE | \$ 190.04 | | |
| | | LOWE'S AQUAPARK | \$ 4,413.00 | | |
| | | Deck at dock | \$ 9,000.00 | | |
| | | FLOATING DOCK | \$ 14,000.00 | | |
| | | ELECTRICAL | \$ 5,000.00 | | |
| | | SEWER | \$ 2,000.00 | | |
| | | WATER | \$ 1,000.00 | | |
| | | PUMP STATION | \$ 9,275.00 | | |
| | | | | | |
| | | | | | |
| | | | | | |
| | | | \$ 123,624.13 | | |
| | | | | | |

Revenues for Lincolnshire Park

6/30/2020

Pool \$16,872

Concessions \$16,517 (Town operated)

Aqua Park \$19,727

6/30/2023

Pool \$24,125

Concessions \$1,448 (outsourced)

Aqua Park \$8,154

6/30/2021

Pool \$28,646.81

Concessions \$1,657 (outsourced)

Aqua Park \$3,713

6/30/2024

Pool \$53,760

Concessions \$10,743 (Town operated)

Aqua Park \$12,626

6/30/2022

Pool \$33,952

Concessions \$3,089 (outsourced)

Aqua Park \$12,942

Total 5 years

Pool \$157,355

Concessions \$33,454

Aqua Park \$57,162

Expenses for Lincolnshire Park

6/30/2020

Part Time Salaries \$43,852
 Pool Operation \$8,725
 Concessions \$11,972 (Town operated)
 Aqua Park \$16,495

6/30/2021

Part Time Salaries \$31,679
 Pool Operation \$3,648
 Concessions \$470 (outsourced)
 Aqua Park \$7,285

6/30/2022

Part Time Salaries \$46,875
 Pool Operation \$7,713
 Concessions \$768 (outsourced)
 Aqua Park \$2,509

6/30/2023

Part Time Salaries \$49,451
 Pool Operation \$5,971
 Concessions \$765 (outsourced)
 Aqua Park \$13,135

6/30/2024

Part Time Salaries \$47,189
 Pool Operation \$6,555
 Concessions \$4,062 (Town operated)
 Aqua Park \$4706

Total 5 years

Part Time Salaries \$219,046
 Pool Operation \$32,612
 Concessions \$18,037
 Aqua Park \$44,130